

Well no : 30/ 9-03 A

Operator : HYDRO

Coordinates : 60 28 16.33 N
02 45 37.55 EUTM coord. : 6704071 N
UTM zone 31 : 486827 E

Licence no : 079

Permit no : 406

Rig : NORTRYM

Rig type : SEMI-SUB.

Contractor : GOLAR-NOR OFFSHORE A/S

Bottom hole temperature : 132 deg.C

Elev. KB : 25 M

Spud date : 84.03.06

Water depth : 111 M

Compl. date : 84.05.20

Total depth : 4300 M

Spud class. : WILDCAT

Age at TD : TRIASSIC

Compl. class. : P&A. OIL/GAS DISC.

Seis. loc. : NH 82 - 065 SP. 377

LICENSEES

 16.000 NORSK HYDRO PRODUKSJON A.S
 10.500 SAGA PETROLEUM A.S.
 73.500 DEN NORSKE STATS OLJESELSKAP A.S

CASING AND LEAK-OFF TESTS

Type	Casing diam.	Depth below KB	Hole diam.	Hole depth below KB	Lot mud eqv. g/cm ³
CONDUCTOR	30	221.0	36	222.0	
SURF.COND.	20	616.0	26	625.0	
INTERM.	13 3/8	1539.0	17 1/2	1715.0	1.65
CASINGS IN 30/9-3 A:					
INTERM.	9 5/8	3251.0	12 1/4	3268.0	1.71
OPEN HOLE			8 3/8	4300.0	

CONVENTIONAL CORES

Core no.	Intervals cored meters	Recovery		Series
		M	%	
1	1795.0 - 1804.5	9.5	100.0	EOCENE
2	2853.0 - 2861.0	8.0	100.0	MIDDLE JURASSIC
3	2861.0 - 2873.0	11.3	94.2	MIDDLE JURASSIC
4	2873.0 - 2891.5	18.2	98.4	MIDDLE JURASSIC
5	2891.5 - 2909.5	18.0	100.0	MIDDLE JURASSIC
6	2909.5 - 2928.0	17.8	96.2	MIDDLE JURASSIC
7	2929.0 - 2951.0	23.0	104.5	MIDDLE JURASSIC
8	2951.0 - 2968.0	17.0	100.0	MIDDLE JURASSIC
9	2968.0 - 2981.0	12.3	94.6	MIDDLE JURASSIC
10	2981.0 - 2982.0	0.8	80.0	MIDDLE JURASSIC
11	2982.0 - 3009.0	23.0	85.2	MIDDLE JURASSIC
12	3009.0 - 3018.0	9.0	100.0	MIDDLE JURASSIC
13	3018.0 - 3036.5	18.5	100.0	MIDDLE JURASSIC
14	3084.0 - 3102.5	18.5	100.0	MIDDLE JURASSIC

MUD PROPERTIES

Depth below KB meter	Mud weight g/cm ³	Plastic viscosity mPa.s	Mud type
1590.0	1.44	30.0	OIL BASED
2625.0	1.46	33.0	OIL BASED
2880.0	1.45	39.0	OIL BASED
3175.0	1.46	37.0	OIL BASED
3285.0	1.30	24.0	OIL BASED
3610.0	1.31	29.0	OIL BASED
3790.0	1.30	33.0	OIL BASED
3900.0	1.31	33.0	OIL BASED
3980.0	1.30	36.0	OIL BASED
4180.0	1.31	37.0	OIL BASED
4255.0	1.26	39.0	OIL BASED

DRILL STEM TEST

INTERVALS AND PRESSURES

Test no.	Interval meter	Choke size	Pressure (PSI)		
			FSIP	BTHP	WHP
1.0	2916.0 - 2910.0	38.1			442.0

RECOVERY

Test no.	Oil Sm ³ /d	Gas M Sm ³ /d	Oil grav. g/cm ³	Gas grav. rel. air	GOR m ³ /m ³
1.0	800	108	0.854	0.710	135

DRILL BIT CUTTINGS AND WET SAMPLES

SAMPLE TYPE	INTERVAL BELOW KB	NUMBER OF SAMPLES
CUTTINGS	1545 - 4300	720
WET SAMPLES	1545 - 4300	900

SHALLOW GAS

INTERVAL BELOW KB	REMARKS
	NONE

AVAILABLE LOGS

LOG TYPE	INTERVALS	1/200	1/500
DIFL BHC AC GR	130 - 1713		X
DIFL BHC AC	1475 - 4298		X
DIFL BHC AC	1475 - 2949	X	
DIFL BHC AC	2830 - 3262	X	
DIFL BHC AC	3249 - 4298	X	
CDL CNL	1525 - 2946	X	
CDL CNL	2830 - 3260	X	
CDL CNL	3249 - 4298	X	
CDL CNL	1525 - 4298		X
CDM	2000 - 3260	X	
CDM	3249 - 4298	X	
CDM AP	2000 - 3260	X	X
CDM AP	3249 - 4298	X	X
SPECTRALOG	2830 - 3145	X	X
FMT	2451 - 2886		X
FMT	3852 - 3948		X
FMT	3706 - 4198		X
CBL VDL AC	1450 - 2753	X	
CBL VDL AC	2700 - 3247	X	
MUD	1539 - 4300		X
VELOCITY (S.C.L.)	1475 - 4298		X
(+ Geogram, Synthetic Seismogram, 2 m/s, nor.pol., 1 stk)			
(+ Vertical V.S.P., 332 - 4300 1 stk)			

DAILY DRILLING REPORT SYSTEM

Main operation : 30/09-03 A

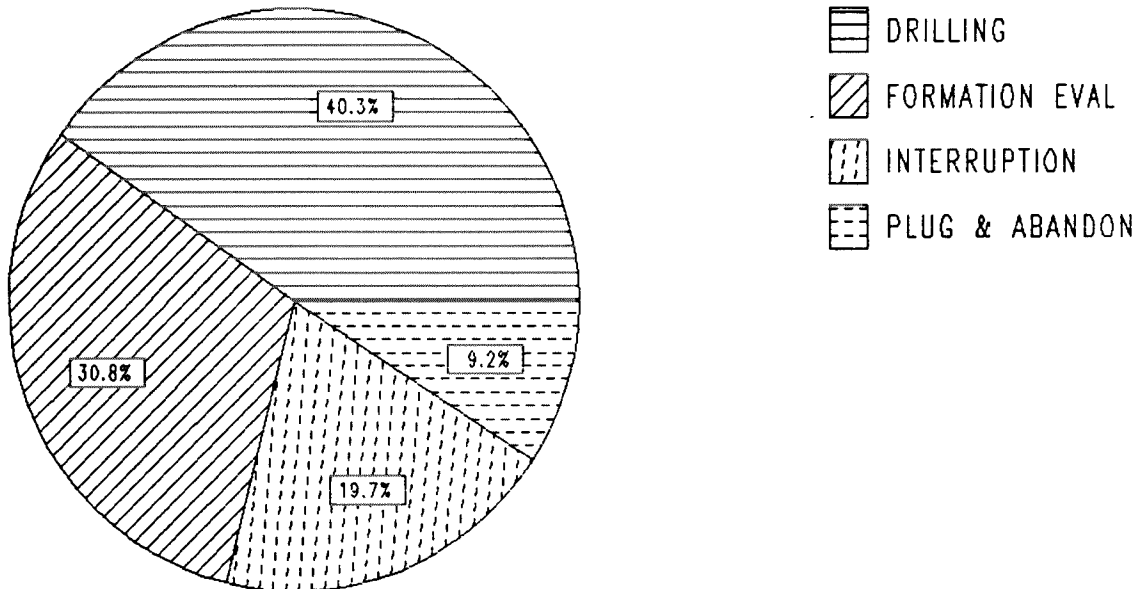

Total : 2029,50 HRS

Main operation	Hours	% of total
DRILLING	817,00	40,26
FORMATION EVAL	625,00	30,80
INTERRUPTION	400,00	19,71
PLUG & ABANDON	187,50	9,24

DEPTH V.S. TIME FOR WELLS:

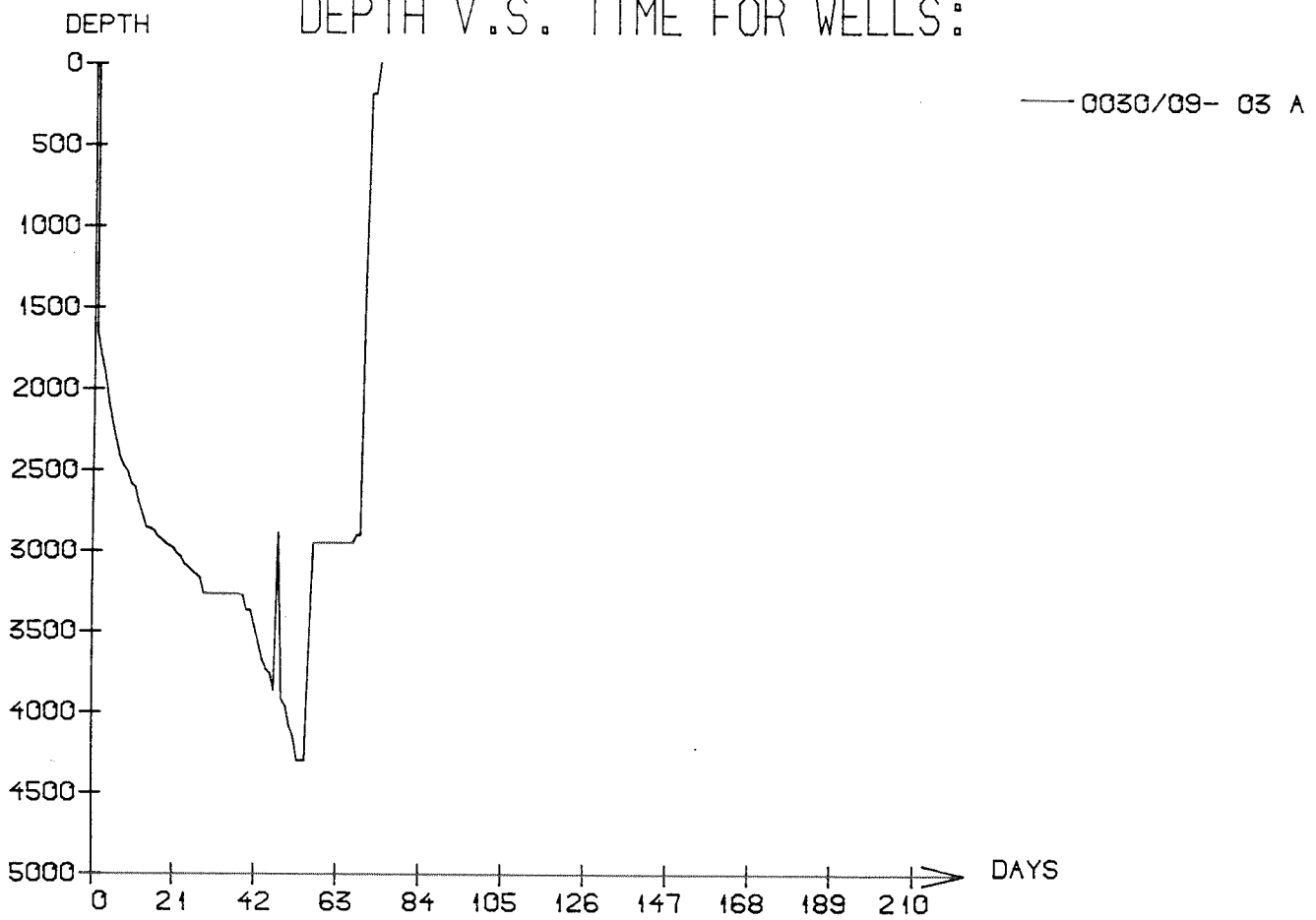

WELL: 003009 03A PRESSURE COMPOSITE PLOT

DEPTH
(RKB)
(METERS)

CASING

PRESSURE GRADIENTS
(g/ccm)

— MUDWEIGHT (REPORT)
- - - PORE PRESSURE (REPORT)
x LEAK-OFF (REPORT)

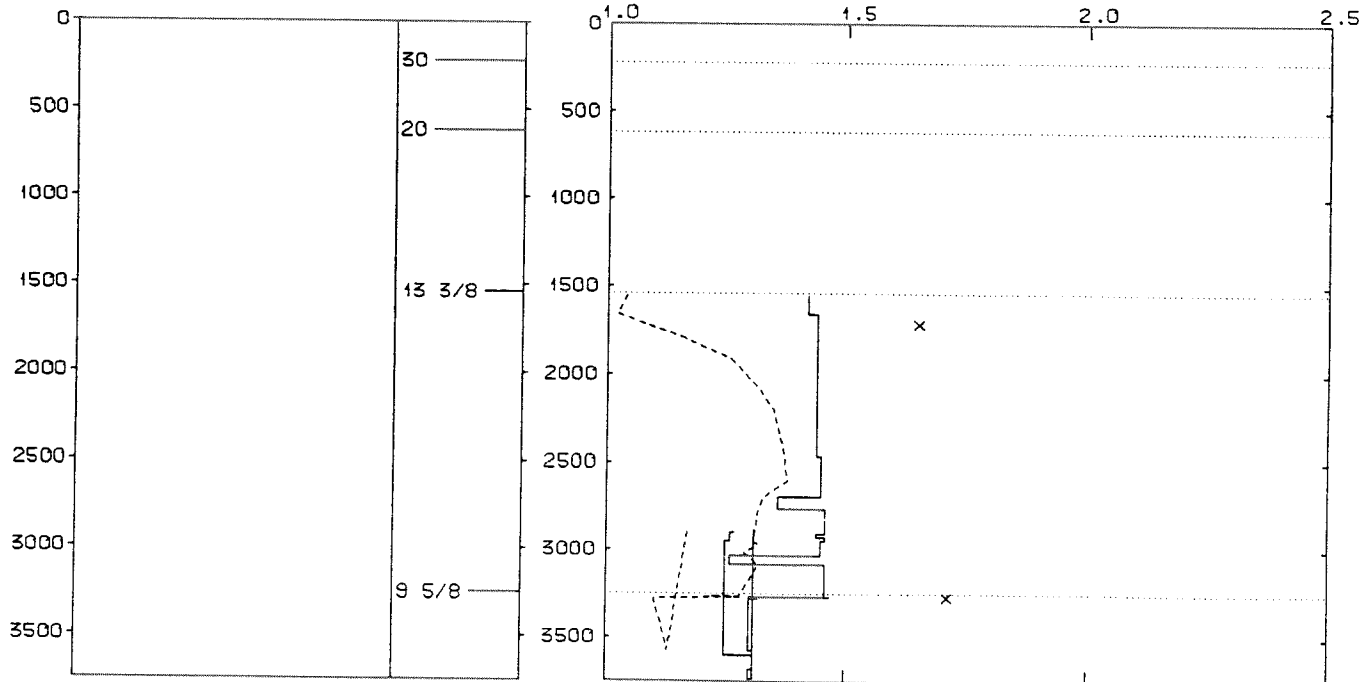

WELL HISTORY - 30/9-3 A

GENERAL:

The well 30/9-3 A was drilled to fulfill the objectives of the well 30/9-3. The main objective of the well 30/9-3 A was to test the hydrocarbon bearing sandstones in the Brent Group which was encountered in the well 30/9-3. Secondary objectives were to find possible hydrocarbon accumulations in the Lower Jurassic Statfjord Formation and to test Triassic at a structurally high position. The well 30/9-3 A encountered hydrocarbons in the Middle Jurassic Brent Group. No other hydrocarbon bearing intervals were encountered by this well.

OPERATIONS:

The well 30/9-3 A was kicked off from 30/9-3 at 1539 m 06.03.84 by the semi-submersible rig Nortrym. Fourteen cores were cut, one core was cut in the Eocene, the rest of the cores were cut in the Middle Jurassic sequence.

No major problems occurred due to drilling.
The well was drilled using oil based mud.

TESTING:

One DST was performed in the oil zone in the Ness Formation.

GEOLOGICAL TOPS

WELL: 30/ 9-03 A

	Depth m (RKB)
<i>Hordaland Group</i>	1540.000
<i>Rogaland Group</i>	2075.000
<i>Balder Fm</i>	2075.000
<i>Sele Fm</i>	2170.000
<i>Lista Fm</i>	2271.000
<i>Våle Fm</i>	2410.000
<i>Shetland Group</i>	2424.000
<i>Brent Group</i>	2853.500
<i>Ness Fm</i>	2853.500
<i>Rannoch/Etive Fm</i>	3059.000
<i>Dunlin Group</i>	3133.000
<i>Drake Fm</i>	3133.000
<i>Cook Fm</i>	3455.000
<i>Burton Fm</i>	3466.000
<i>Amundsen Fm</i>	3566.000
<i>Statfjord Fm</i>	3679.000
<i>Raude Member</i>	4161.000
<i>Hegre Group</i>	4249.000
<i>Lunde Fm</i>	4249.000
<i>TD =</i>	4300.000